

| TABLE "A" Rafter Spans (DF #2 or Better) | | |
|---|----------|---------|
| Size | Space | Span |
| 2x4 | 12" o.c. | 9' 6" |
| | 16" o.c. | 8' 0" |
| | 24" o.c. | 6' 6" |
| | 32" o.c. | 6' 0" |
| 2x6 | 48" o.c. | 5' 6" |
| | 12" o.c. | 16' 6" |
| | 16" o.c. | 14' 6" |
| | 24" o.c. | 12' 0" |
| 2x8 | 32" o.c. | 10' 4" |
| | 48" o.c. | 8' 0" |
| | 12" o.c. | 20' 6" |
| | 16" o.c. | 17' 9" |
| 2x10 | 24" o.c. | 14' 10" |
| | 32" o.c. | 12' 8" |
| | 48" o.c. | 11' 6" |
| | 12" o.c. | 26' 8" |
| 4x4 | 16" o.c. | 23' 6" |
| | 24" o.c. | 18' 11" |
| | 32" o.c. | 16' 2" |
| | 48" o.c. | 14' 0" |
| 4x6 | 24" o.c. | 10' 0" |
| | 32" o.c. | 9' 5" |
| | 48" o.c. | 7' 8" |
| | 24" o.c. | 15' 11" |
| 4x8 | 32" o.c. | 13' 9" |
| | 48" o.c. | 11' 3" |
| | 24" o.c. | 20' 6" |
| | 32" o.c. | 19' 0" |
| | 48" o.c. | 16' 0" |

| TABLE "B" Header Size & Spans (DF #2 or Better) | | |
|--|------|------|
| Rafter Span | Span | Size |
| Up to 12' | 8' | 4x6 |
| | 10' | 4x8 |
| | 12' | 4x10 |
| | 14' | 4x10 |
| Up to 20' | 16' | 4x10 |
| | 8' | 4x8 |
| | 10' | 4x10 |
| | 12' | 4x12 |
| | 14' | 4x12 |

| TABLE "C" Post footings min of 12" below grade | | | | | |
|--|---------------|--------------|-------|-------|-------|
| Rafter Span | Post Location | Post Spacing | | | |
| | | 8' | 10' | 12' | 14' |
| up to 12' | interior | 12x12 | 14x14 | 16x16 | 16x16 |
| | end | 12x12 | 12x12 | 14x14 | 14x14 |
| up to 16' | interior | 14x14 | 16x16 | 18x18 | 18x18 |
| | end | 12x12 | 14x14 | 14x14 | 16x16 |
| up to 20' | interior | 16x16 | 18x18 | 18x18 | 20x20 |
| | end | 14x14 | 16x16 | 16x16 | 16x16 |

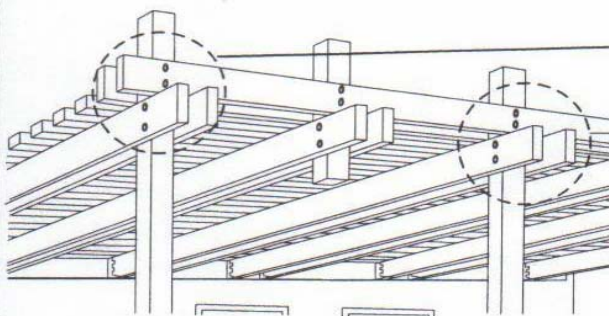

TWO 5/8" DIA. THRU-BOLTS PER CONNECTION AS SHOWN

TWO 2X MEMBERS MAY BE SUBSTITUTED FOR ONE 4X MEMBER. SEE TABLES "A" & "B" FOR SPAN LIMITS

THIS SPACING AND SPAN IS FOR LATTICE COVERINGS ONLY
LIMIT DICTATED BY HEADER DESIGN (TABLE "B").
SHEAR WALLS MAY NOT BE MODIFIED UNLESS
STRUCTURAL CALCULATIONS ARE SUBMITTED AND
APPROVED BY THE BUILDING DEPARTMENT.



BUILDING DIVISION

LATTICE PATIO DETAIL

760-435-3950

FAX (760) 435-3926

**300 N. COAST HWY
OCEANSIDE, CA 92054**

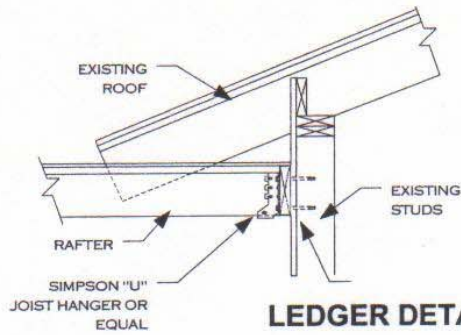

LEDGER DETAIL

USE A CONTINUOUS 2X LEDGER, SAME DEPTH AS THE RAFTERS, WITH 1/2" DIA. X 5" LAG BOLTS TO EACH STUD (16" o.c.) WHEN THE RAFTER SPAN IS GREATER THAN OR EQUAL TO 14'-0", USE 5/8" DIA. X 5" LAG BOLTS. * ALL PILOT HOLES TO BE DRILLED A SINGLE SIZE SMALLER THAN LAG BOLT DIA. NO COUNTERSINKING OF LAG BOLTS UNLESS A SOLID 3X MEMBER IS USED IN PLACE OF 2X.

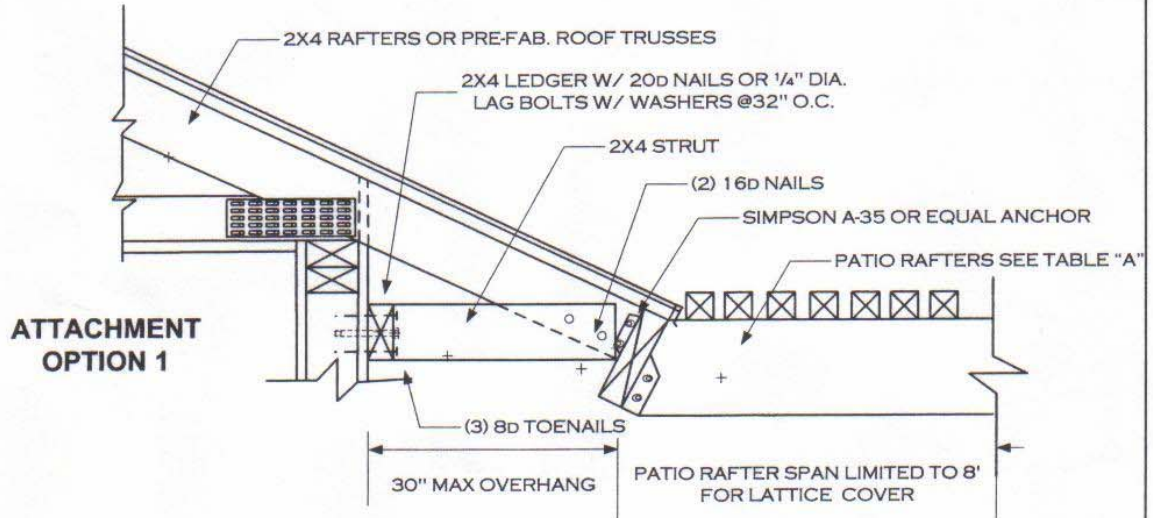

ATTACHMENT OPTION 1

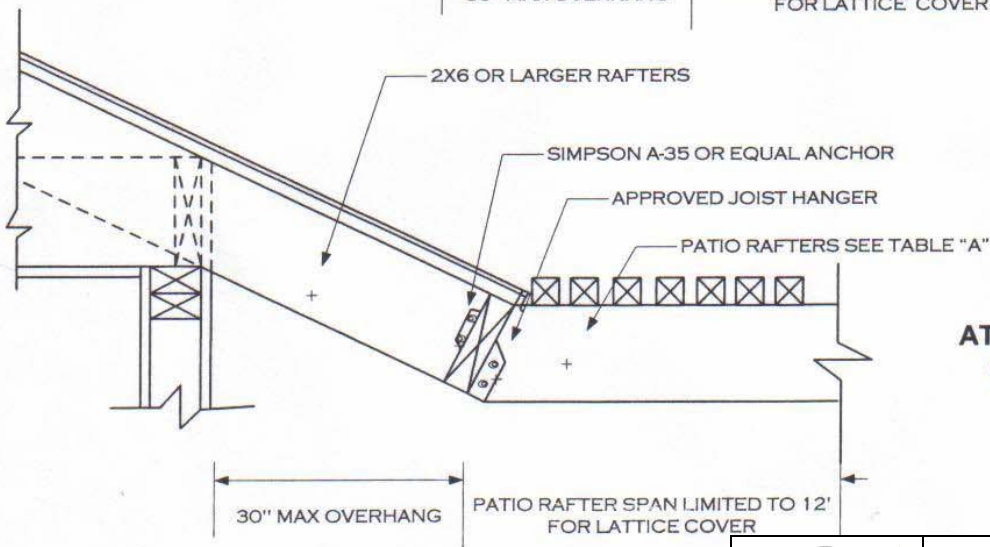

ATTACHMENT OPTION 2



BUILDING DIVISION

LATTICE PATIO DETAIL

300 N. COAST HWY
OCEANSIDE, CA 92054

760-435-3950

FAX 760-435-3926

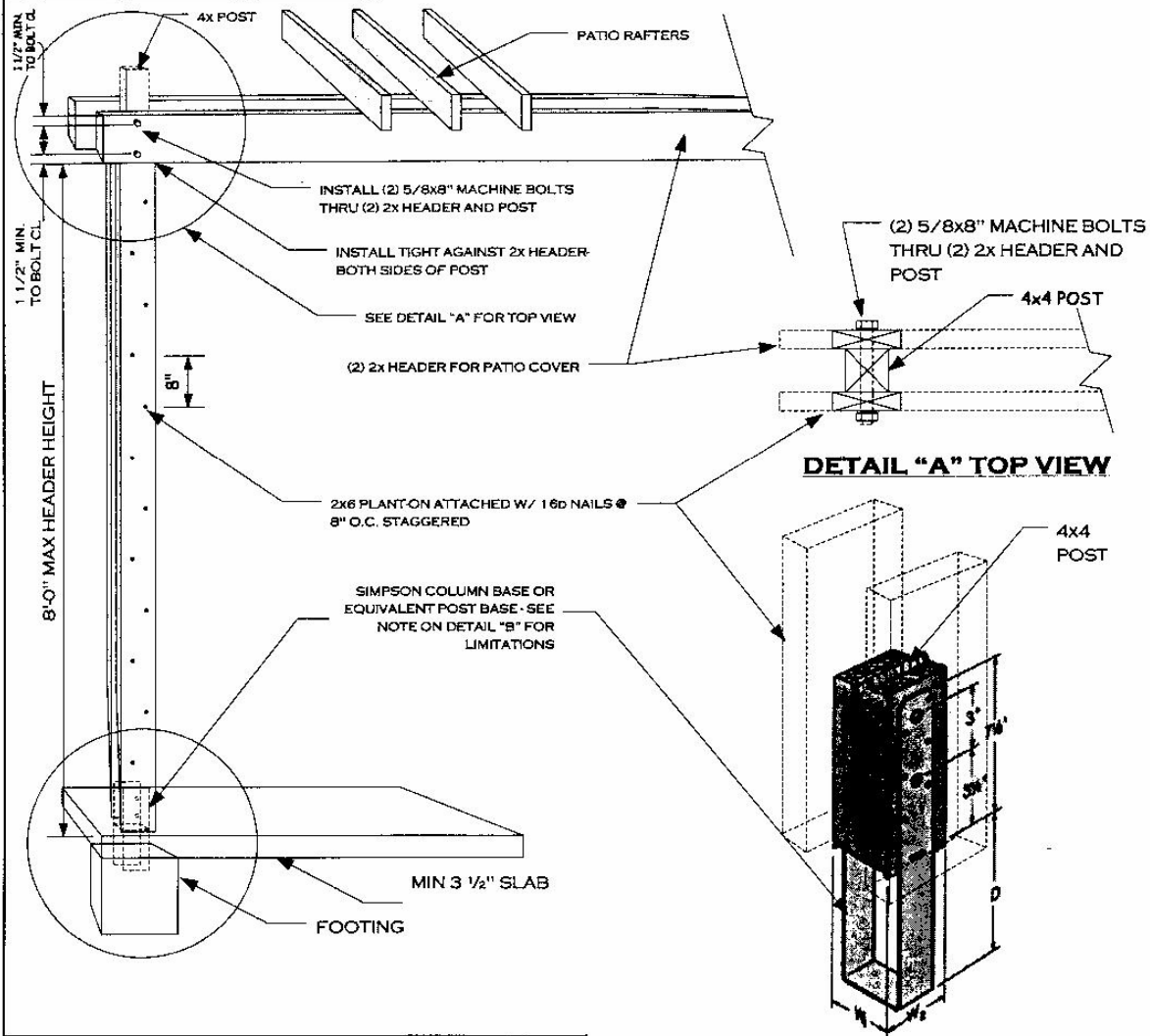

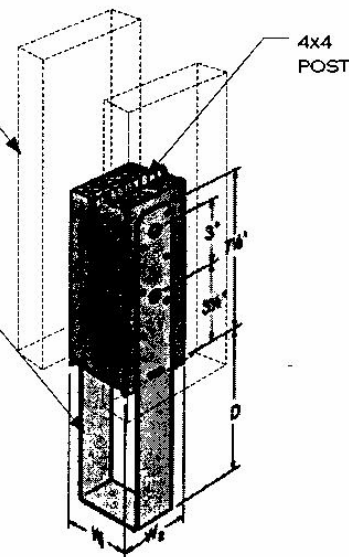

DETAIL "A" TOP VIEW

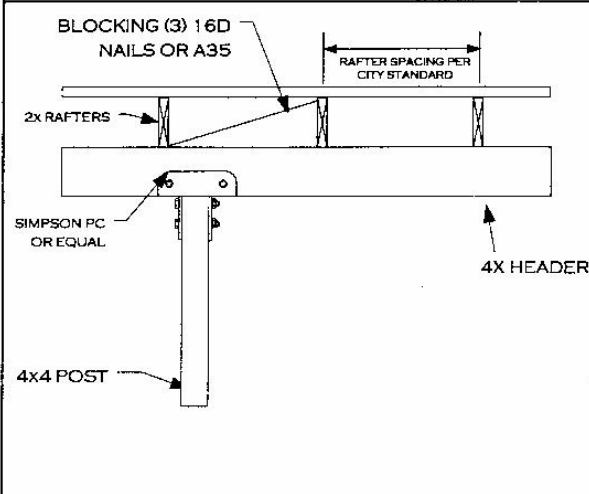

DETAIL B

NOTE: SIMPSON COLUMN BASE OR A POST BASE THAT PROVIDES AN EQUIVALENT VALUE MUST BE USED WITH THE ALTERNATE BRACING DETAIL. LCB POST BASES AND SIMILAR SUBSTITUTES MAY NOT BE USED WHEN THIS ALTERNATE TO THE STANDARD REQUIRED BRACING IS USED. INSTALL PER MANUFACTURERS INSTALLATION GUIDELINES



| | |
|---|---|
|  | BUILDING DIVISION |
| | LATTICE PATIO |
| | 300 N. COAST HWY OCEANSIDE, CA 92054 |
| 760 435-3950 | |
| FAX 760-435-3926 | |